



Copyright © 2016
 Offington Land Surveys Ltd
 29 Offington Drive
 Worthing
 West Sussex BN14 5PW
 Tel/fax 01903 267883
 surveyors@offington.com

Job: XXXX
 XXXX
 XXXX

Drawing No: XXXXXXXX Site Plan

Client: XXXX

Version: 1.0
 Publication Date: ---
 Plot Scale: 1:500
 Sheet Size: A3 Landscape
 Sheet: 1 of 1
 Survey Drawn: ---
 Reviewed: BT
 Checked by: JTV
 Drawn by: BT

STANDARD REFERENCE
 Datum Used: Newlyn
 Survey Standard: ODN & OSBM by non-survey best fit to GPS RTK control (OSB accuracy to 5mm mean)
 Survey Station Shows That:
 Foot Water Drainage: ---
 Storm Water Drainage: ---
 Water Mains: ---
 Gas Mains: ---
 Electricity Cables: ---
 British Telecom Cables: ---

The above information is for information only.
 The details shown herein including all underground services are as obtained by normal above-ground survey observation and methods and where indicated also by reference to available utility records. Although all reasonable efforts have been made no guarantee can be given for the completeness or accuracy of the information.

ABBREVIATIONS

BL	Best Level	IC	Inspection Chamber
BT	British Telecom (C)	LC	Level Line
CB	Concrete Block	MB	Manhole
CC	Concrete Casing	MC	Manhole Cover
CL	Cable Level	MS	Manhole Sign
CM	Cable Marker	NS	Non-Survey
CP	Cable Pit	OWP	Open Water Pipe
CP	Cable Pit	SC	Shop Curb
EDP	Electricity Cable Pit	SH	Service Housing
EP	Electricity Pole	SW	Shop Window
FA	Fire Alarm	SW	Shop Window
FB	Fire Bell	TV	Television Pipe
FL	Flow Level	VF	Vert. Flow Pipe
FM	Footpath	WM	Water Main
G	Gully	WO	Water Wash Out

FENCES

FCL	Chain Fenced	FFR	Flint Wall
FCL	Chain Fenced	FRF	Flint & Rail
FCL	Chain Fenced	FRW	Flint & Wire
FR	Flint	FT	Flint
FR	Flint	FT	Flint

STATION SCHEDULE

Station	Easting (m)	Northing (m)	Level (m)
1	XXX325.484	XXX031.278	7.000
2	XXX327.811	XXX030.282	7.000
3	XXX330.495	XXX031.980	7.010
4	XXX332.285	XXX031.488	7.110
5	XXX334.070	XXX031.978	7.000
6	XXX335.855	XXX031.488	6.990
7	XXX337.640	XXX031.980	7.000
8	XXX339.425	XXX031.488	6.990
9	XXX341.210	XXX031.980	7.000
10	XXX342.995	XXX031.488	7.010
11	XXX344.780	XXX031.980	7.000
12	XXX346.565	XXX031.488	7.010

TREE SCHEDULE

Number	Girth (m)	Spread (m)	Height (m)	Species
T.1	1.7	1.2	12	maple
T.2	1.2	0.8	8	ash
T.3	1.0	0.7	6	not identified
T.4	1.0	0.7	6	not identified
T.5	0.8	0.6	6	holly
T.6	0.8	0.6	6	holly
T.7	0.8	0.6	6	holly
T.8	0.7	0.5	5	not identified
T.9	1.0	1.0	10	maple
T.10	1.1	1.0	12	maple
T.11	0.8	0.7	8	holly
T.12	0.8	0.7	8	holly
T.13	0.8	0.7	8	holly
T.14	0.8	0.7	8	not identified
T.15	0.8	0.7	8	holly
T.16	0.8	0.7	8	not identified
T.17	0.8	0.7	8	not identified
T.18	0.8	0.7	8	not identified
T.19	0.8	0.7	8	not identified
T.20	0.8	0.7	8	not identified
T.21	0.8	0.7	8	not identified
T.22	0.8	0.7	8	not identified
T.23	0.8	0.7	8	not identified
T.24	0.8	0.7	8	not identified
T.25	0.8	0.7	8	not identified
T.26	0.8	0.7	8	not identified
T.27	0.8	0.7	8	not identified
T.28	0.8	0.7	8	not identified
T.29	0.8	0.7	8	not identified
T.30	0.8	0.7	8	not identified
T.31	0.8	0.7	8	not identified
T.32	0.8	0.7	8	not identified
T.33	0.8	0.7	8	not identified
T.34	0.8	0.7	8	not identified
T.35	0.8	0.7	8	not identified
T.36	0.8	0.7	8	not identified
T.37	0.8	0.7	8	not identified
T.38	0.8	0.7	8	not identified
T.39	0.8	0.7	8	not identified
T.40	0.8	0.7	8	not identified
T.41	0.8	0.7	8	not identified
T.42	0.8	0.7	8	not identified
T.43	0.8	0.7	8	not identified
T.44	0.8	0.7	8	not identified
T.45	0.8	0.7	8	not identified
T.46	0.8	0.7	8	not identified
T.47	0.8	0.7	8	not identified
T.48	0.8	0.7	8	not identified
T.49	0.8	0.7	8	not identified
T.50	0.8	0.7	8	not identified

Tree spread and height are approximate. If identified, species should be reported on an assessed survey verified by a qualified expert.

NOTES

SCALE BAR
 0m 10m

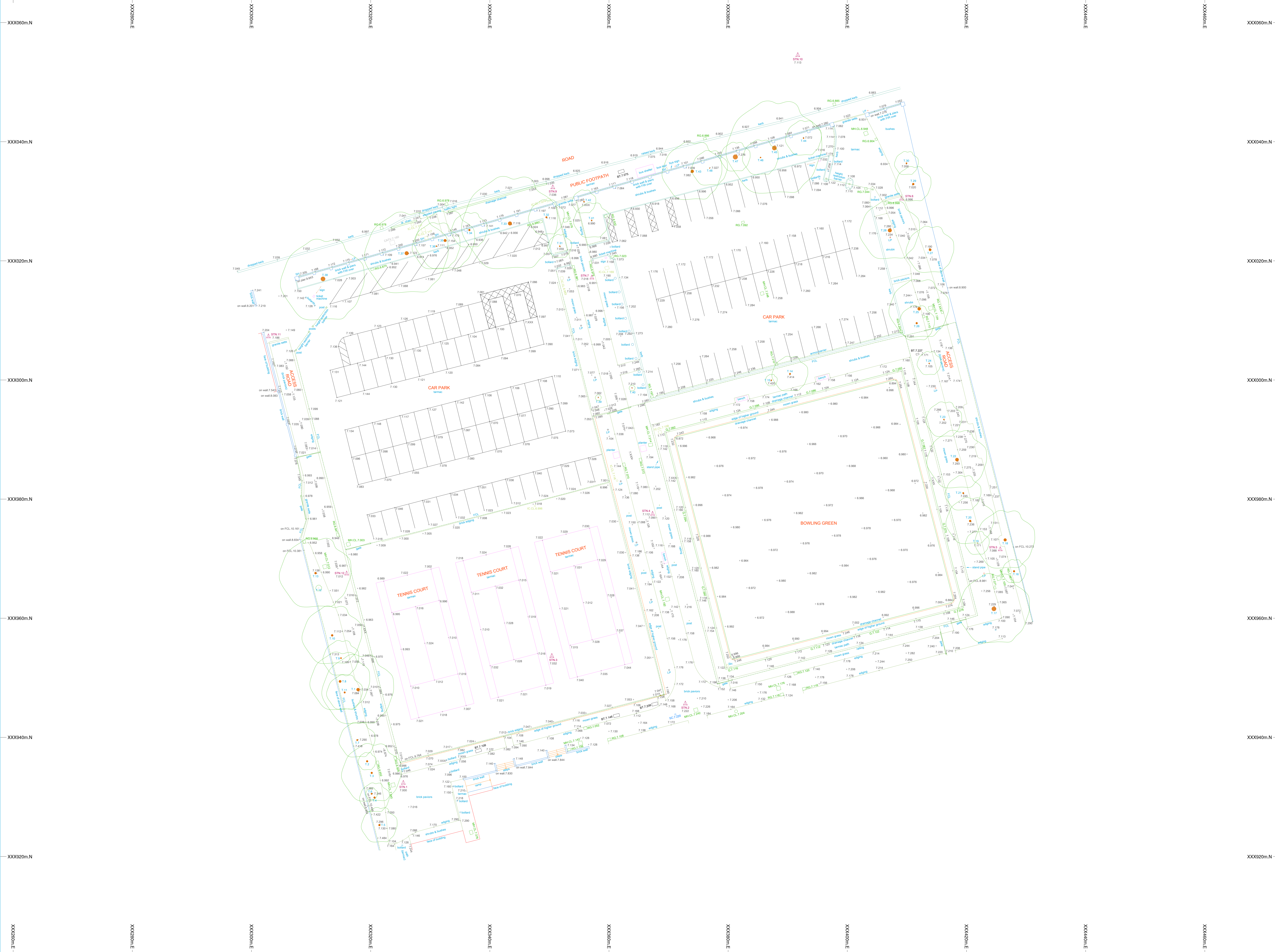

XXX060m.N
 XXX040m.N
 XXX020m.N
 XXX000m.N
 XXX980m.N
 XXX960m.N
 XXX940m.N
 XXX920m.N

XXX060m.E
 XXX080m.E
 XXX100m.E
 XXX120m.E
 XXX140m.E
 XXX160m.E
 XXX180m.E
 XXX200m.E
 XXX220m.E
 XXX240m.E
 XXX260m.E
 XXX280m.E
 XXX300m.E
 XXX320m.E
 XXX340m.E
 XXX360m.E
 XXX380m.E
 XXX400m.E
 XXX420m.E
 XXX440m.E
 XXX460m.E
 XXX480m.E
 XXX500m.E